



03Spaces Workplace

Version 2.4.0 Patch 1

32.8.56xx

Release Notes

© 2006 - 2009 03Spaces B.V.

All product names, logos, brands and any other trademarks contained in this document are the property of the respective owners.



Table of Contents

Important notes before installing O3Spaces Workplace 2.4.0 patch 1.....	4
Important notes Community Edition (CE).....	4
Community Edition not intended for production environments.....	4
Updating a Community Edition from 2.3.0 or older to 2.4.0 patch 1 is not possible.....	4
Important notes Professional Edition (EE) and Enterprise Edition (EE).....	4
Upgrading a Community Edition (CE) to a Professional Edition (PE) or an Enterprise Edition (EE).....	4
Updating from version 2.3.0 or older to version 2.4.0 patch 1.....	4
Important note before updating from 2.2.1 or older.....	5
O3Spaces Workplace 2.4.0 Patch 1.....	5
Functional distinction between editions.....	5
Community Edition.....	5
Professional Edition.....	6
Enterprise Edition.....	6
New features in O3Spaces Workplace 2.4.0.....	6
E-mail archiving features (Enterprise Edition only).....	6
Other 2.4.0 improvements.....	8
Key features in O3Spaces Workplace.....	9
Release 2.4.0 - Patch 1 (32.56xx).....	11
OpenOffice.org / StarOffice plug-in.....	12
OpenOffice.org / StarOffice plug-in prerequisites.....	12
Microsoft Office plug-in.....	13
Microsoft Office plug-in prerequisites.....	13
Microsoft Outlook plug-in (Enterprise Edition only).....	13
Microsoft Outlook plug-in prerequisites.....	13
Using 'create new workspaces as Workspace user' functionality.....	13
Known Issues.....	14
Localizations of Workplace 2.4.0 patch 1.....	14
Managing roles on sub-unit level.....	14
Un-install Workplace 2.1 plug-in before installing Workplace 2.4.0 plug-in.....	14
Un-installing O3Spaces Workplace Debian or RPM packages.	14
Two O3Spaces Workplace instances on one Tomcat Application Server.....	14
LDAP synchronization and maximum number of users.....	14
Downloads from IE fail over SSL.....	15
Firefox and Java Web Start on Linux and Solaris operating systems.....	15
Workplace on SLES.....	15
Safari and Java-check on Windows operating system.....	15
Context menus in Safari on Mac OS X.....	15
Non-ASCII characters in Firefox 1.5.X.....	16
Opening multiple Workplace sessions in Browsers and/or Browser tabs.....	16
Using WebDAV connections on Windows XP and Vista operating systems.....	16
Keynote (.key) files on Mac OS X.....	16
OpenOffice.org 3.0 on Mac OS X.....	16
OpenOffice.org 2.2-2.4 on Ubuntu.....	17
Microsoft Office / Outlook plug-in installation for network installations.....	17



Using embedded Microsoft Excel OLE objects in Microsoft Word.....	17
Contact O3Spaces.....	17
Disclaimer.....	17



Important notes before installing O3Spaces Workplace 2.4.0 patch 1

Read the following sub sections carefully before installing O3Spaces Workplace 2.4.0 patch 1

Important notes Community Edition (CE)

Read the following sub sections carefully if you are using the Community Edition of O3Spaces Workplace.

Community Edition not intended for production environments

The O3Spaces Workplace Community Edition (CE) is a **free-to-use** and **free of charge edition** of the O3Spaces software. The Community Edition enables teams and workgroups **up to 10 people** to collaborate and share their documents.

Note: The O3Spaces Workplace Community Edition is delivered 'as is' and without any warranties or support and is **not intended for nor particularly suited for use in production environments**.

Updating a Community Edition from 2.3.0 or older to 2.4.0 patch 1 is not possible

It is not possible to update a Community Edition of O3Spaces Workplace to version 2.4.0 patch 1 if your current version is 2.3.0 or older.

- Updating from 2.4.0 (build 32.7.5528) to 2.4.0 patch 1 is possible without a new license.
- Continue using a previous version is possible.
- Installing a new Community Edition deployment with version 2.4.0 patch 1 is also possible but your current data will be lost.

Important notes Professional Edition (EE) and Enterprise Edition (EE)

Read the following sub sections carefully if you are using the Professional Edition or Enterprise Edition of O3Spaces Workplace.

Upgrading a Community Edition (CE) to a Professional Edition (PE) or an Enterprise Edition (EE)

Apache Derby database not allowed

Updating from a Community Edition to a Professional Edition or to an Enterprise Edition is not possible. If you want to upgrade a Community Edition please contact sales@o3spaces.com first for migration instructions.

Note: Using the Professional or Enterprise UpdateKit on a Community Edition based Workplace deployment will not function. The Professional Edition or Enterprise Edition license does not allow you to connect with the Apache Derby database (embedded in the Community Edition). Your Workplace Deployment will not function anymore.

Updating from version 2.3.0 or older to version 2.4.0 patch 1

New license required

You will need a new license file if you are updating from a 2.3.0 version. Do not update until you have received this new license file. Without this new license your updated Workplace Deployment will not function anymore.

- Updating from 2.4.0 (build 32.7.5528) to 2.4.0 patch 1 is possible without a new license.



Derby database not allowed

Before updating from a previous version you have to verify that your current Edition is connected with a PostgreSQL or a Microsoft SQL Server database.

Note: The Professional Edition or Enterprise Edition license does not allow you to connect with a Apache Derby database (embedded in Community Edition based deployments). Your Workplace Deployment will not function anymore. Please contact sales@o3spaces.com first for database migration instructions.

Important note before updating from 2.2.1 or older

If you are upgrading from a previous version (2.1 or 2.2.x) to 2.3.x or newer a full re-index of the Lucene and Compass search indexes are required. On existing O3Spaces Workplace deployments with a large repository this re-indexing can take a long time. While rebuilding the indexes, end-users might see wrong or empty files-, workspaces- and users-overviews (in the Workplace Spaces, Studio and Workplace Assistant).

This re-indexing is required if you are updating from a 2.2.1 or previous version and will start automatically as soon as the Workplace server –with the new 2.3.x (or newer) war-file– is started again.

This update is necessary to support the search functionality (since 2.3.0) in the Workplace Assistant.

O3Spaces Workplace 2.4.0 Patch 1

O3Spaces Workplace is a Web 2.0 Document Management & Collaboration Solution for OpenOffice.org, StarOffice and Microsoft Office users.

Functional distinction between editions

O3Spaces Workplace 2.4 is the first release with a functional distinction between the **Community Edition** and the two production environment suitable Workplace Editions; the **Professional Edition** and the new **Enterprise Edition**.

Note: Some features will not be available in the Community Edition of O3Spaces Workplace 2.4.0 patch 1

Note: Some features will not be available in the Professional Edition of O3Spaces Workplace 2.4.0 patch 1

The main differences between the edition are:

Community Edition

- Free to use and free of charge
- Limited to max.10 users
- Delivered 'as is' and without any warranties or support
- Not intended for nor particularly suited for use in production environments
- No update subscriptions
- Fully functioning O3Spaces Workplace Edition:
 - Workplace Server software
 - Workplace 'Spaces' & 'Studio' user environments
 - Workplace Assistant, desktop integration
 - Workplace integration plug-ins (OpenOffice.org / StarOffice and Microsoft Office)
- Free access to the community forum.



- Database support limited to the embedded Apache Derby database
- Deployment documentation and end-user documentation available after registration.

Professional Edition

- Paid subscriptions for updates and support,
- Intended for production use
- Contains several extra professional product modules such as:
 - Bulk import tools
 - Repository search functionality from the Workplace Assistant
- Database support for PostgreSQL and Microsoft SQL Server (Apache Derby database not allowed)
- Access to the customer support forum
- Deployment documentation available
- End-user documentation available (PDF and integrated in the Workplace)

Enterprise Edition

- Paid subscriptions for updates and support,
- Intended for production use
- Contains several extra enterprise product modules such as:
 - Bulk import tools
 - Repository search functionality from the Workplace Assistant
 - Document Template Management tools for OpenOffice.org and StarOffice
 - E-mail archiving tools (Workplace integration plug-in for Microsoft Outlook and e-mail tabs in workspaces)
 - Extra configuration:
 - Hide option to start the Workplace Assistant
 - Login screen customization (add custom logo)
 - Application Embedder (embed external web-applications in the Workplace)
- Database support for PostgreSQL and Microsoft SQL Server (Apache Derby database not allowed)
- Access to the customer support forum
- Deployment documentation available
- End-user documentation available (PDF and integrated in the Workplace)

New features in O3Spaces Workplace 2.4.0

The main new end-user features in O3Spaces Workplace version 2.4.0 are related to the E-mail archiving functionality.

E-mail archiving features (Enterprise Edition only)

- **Workspace E-mail tab**
Archived e-mail messages will be presented in a separate e-mail tab with an option to read the message and to publish attachments.
- **Microsoft Outlook plug-in**
With the Microsoft Outlook plug-in it will be possible to publish e-mail messages from Microsoft Outlook to a workspace e-mail folder.
Another feature of the plug-in is the possibility to insert files from the Workplace as attachments to new e-mail messages
- **E-mail content search**
Archived e-mail messages are fully indexed by the Workplace search engine.

Note: To use the e-mail archiving features (E-mail tab, Microsoft Outlook plug-in, E-mail content search) you first have to change:



- 1) The workspace template settings, to define which workspace(s) will have an e-mail tab.
 - 2) The e-mail tab properties of individual workspaces, to define which workspace-folder must be visible in the e-mail tab.
- See the tips below for more information about the workspace-template settings and about the e-mail tab properties.

Tip: The visibility of the e-mail tab in workspaces will be defined by its related workspace-template.

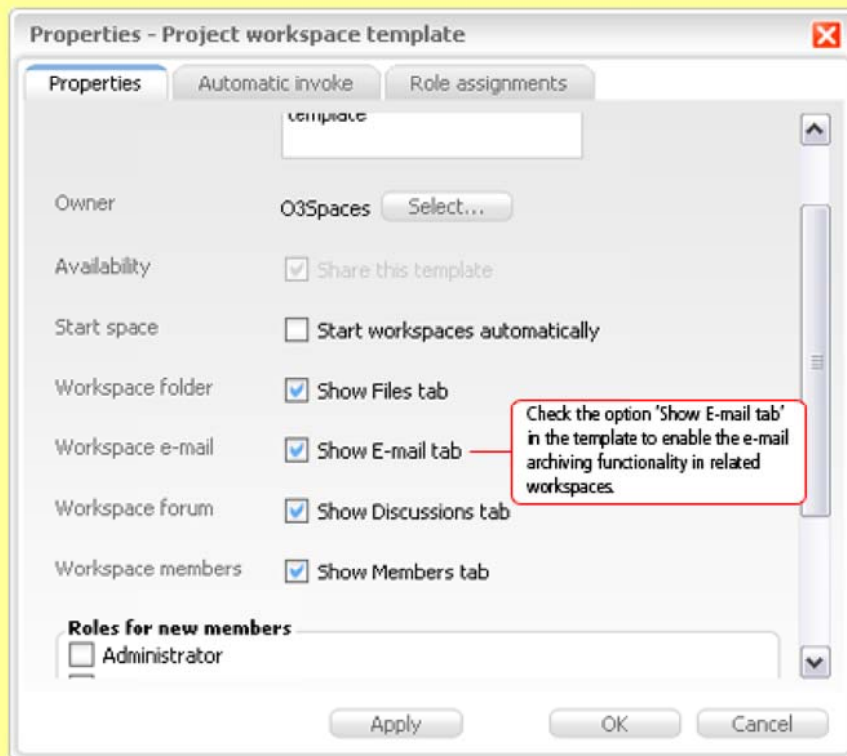

In all existing and in all new workspace-templates the 'Show E-mail tab' option will not be checked by default. To use the e-mail archiving features this option has to be checked in the workspace-template properties.

Tip: Before e-mail message can be displayed in a workspace e-mail tab, a specific workspace folder has to be defined first.

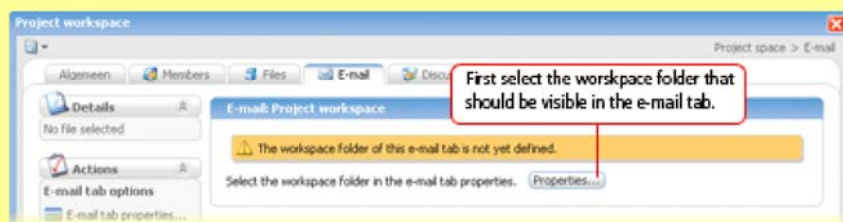

The workspace folder to be visible in the e-mail tab can be selected in the e-mail tab properties. After defining a folder the available e-mail messages will be indexed. This can take some time.

Other 2.4.0 improvements

- **Send a new Workplace invitation e-mail to users at any time**

Send a new or resend the Workplace invitation e-mail, *-with an account activation link-*, to all users of a Unit or to all members of a group or send it to an individual user.



- **Move files and folders in the Workplace Assistant**
Support for moving files and folders between workspaces folders in the Workplace Assistant file-explorer.
- **Support for working without the Workplace Assistant. (Hide option to start the Workplace Assistant) (Enterprise Edition only)**
Interface configuration option to hide the Workplace Assistant status indicator in the Workplace Spaces environment for a specific set of users. This setting can be configured in the Unit settings *-for a all the people within the Unit-* and in the user properties to change the setting for individual users.
- **Login screen customization (Enterprise Edition only)**
Option to add a custom corporate logo in the Workplace Spaces and Studio login screen.
File-dimensions: 270x60 px (other sizes will be scaled) / File-name: logo-lp.png / File-location: wpdata
- **Visual change Spaces and Studio login screen**
The login screen background images of the Spaces and the Studio environment have been redesigned.
- **Enlarged overview navigation icons**
The 'previous' and 'next' overview navigation icons are enlarged. The redesigned icons will improve the overview navigation usability.
- **Major file-versions support**
Possibility to create new major file-versions in the Spaces environment. (2.x, 3.x etc, instead of infinite numbering 1.1, 1.2, 1.3 ... 1.999 etc.)
- **English_UK date-format**
Beside a general English profile (US based), users can select an English (United Kingdom) profile; which will result in displaying dates with an EN_UK date-format.
Example: *25-Dec-2008 16:00* instead of *Dec 25, 2008 4:00 PM* or *25/12/08 16:00* instead of *12/25/08 4:00 PM*
- **New Russian localization**

Key features in O3Spaces Workplace

An overview of the key product features are listed below.

Cross platform

- O3Spaces provides you the freedom of choice, whether you use a Linux, Solaris, Windows or Mac desktop, O3Spaces will provide its full range of functionality, web-client, desktop integration and Office integration.

End-User functionality

- **Workplace Assistant, Office plug-in and E-mail client plug-in**
 - **Desktop integration**
Stay up to date without having your web browser open. The O3Spaces Workplace Assistant provides real-time notification on all relevant changes in your workspaces. Furthermore, the Assistant automates all necessary document retention and versioning activities when you work on your documents. It provides easy navigation to your workspaces, allows for off-line work and offers direct control on your locked files.
 - **Application style Workplace Assistant interface**
The user interface for the Workplace Assistant presents the end-user with all the Workplace Assistant functionality in a user friendly setting.
 - **Workplace Assistant with drag & drop Workplace repository file browser**
The new Workplace assistant file browser brings improved repository access to the desktop. Multiple files and folders can be easily uploaded via drag & drop into your workspace folders.



- **Search in Workplace repository (Professional & Enterprise Editions only)**
Search in workspace folders from the Workplace Assistant.
- **Manage local locked files**
Enhances your control of the check-in & check-out process, improving e.g. synchronization of off-line work.
- **Office integration**
Open shared files from your workspaces, or publish your document to a team-site directly from your Office application. Review document versions, add comments and stay up to date. Collaborate and enhance your office productivity without having a web browser open. Turn OpenOffice.org / StarOffice or Microsoft Office into an enterprise grade web2.0 document centric collaboration environment.
 - **Microsoft Office support on Windows Vista**
Workplace offers compatibility for the supported Microsoft Office versions (Microsoft Office XP, 2003 and 2007) on Windows 2000, XP and Vista.
 - **OpenOffice.org Assistant control**
A usability enhancement allowing you to control the Workplace Assistant status and connect to the Workplace directly from OO.o.
 - **Document Template Management (Enterprise Edition only)**
Functionality for the administration and distribution of 'document templates' & 'corporate identity'. Accessible in OpenOffice.org.
- **E-mail client integration**
 - **Microsoft Outlook integration (Enterprise Edition only)**
Publish e-mail messages to e-mail folders in workspaces directly from Microsoft Outlook. Insert files from the Workplace as attachment to new e-mail messages.
- **Workplace browser and repository functionality**
 - **Web 2.0 AJAX web-client**
O3Spaces' web based workplace environment provides the main graphical user interface that can be accessed with a web browser. It presents organized easily accessible workspaces for teams, workgroups and projects. It houses powerful advanced search functions that allow full text search of ODF, PDF and Microsoft Office documents.
 - **Double-click behavior for default actions**
Usability enhancement in the Studio & Spaces browser environments enabling common double-click behavior
 - **Search & Sort in overviews**
Usability enhancement in the Studio & Spaces browser environments enabling searching and sorting the information in various overviews (documents, users, groups, etc.)
 - **Anonymous access**
Access the Workplace repository with 'anonymous access' to link Workplace content to Wiki's, Portals & Websites.
 - **Multiple File Upload**
Functionality supporting multiple file uploads in the Browser environments. New non-blocking uploads allow you to continue work while uploading.
 - **Create new workspaces as Workspace user**
Functionality allowing users with administrative permissions to create new Workspaces from the End-user Spaces environment.
 - **Web Interface improvements**
 - Resizable browser interface.
 - Smart loading and rendering performance (better responsiveness).
 - **Localization**
Working in your own native language. O3Spaces supports multiple interface languages (English, Dutch,



French, German, Japanese, Russian, Spanish, Swedish and Polish) and new localizations can be added easily.

System & Admin functionality

- **Send a new Workplace invitation e-mail to users at any time**
Send a new or resend the Workplace invitation e-mail, *-with an account activation link-*, to all the users of a Unit or to all members of a group or send it to an individual user.
- **Support for working without the Workplace Assistant. (Hide option to start the Workplace Assistant) (Enterprise Edition only)**
Interface configuration option to hide the Workplace Assistant status indicator in the Workplace Spaces environment for a specific set of users. This setting can be configured in the Unit settings, *-for all people within the Unit-*, and in the user properties to change the setting for individual users.
- **Login screen customization (Enterprise Edition only)**
Option to add a custom corporate logo in the Workplace Spaces and Studio login screen.
- **File system - Bulk Import (Professional & Enterprise Editions only)**
Studio functionality enabling you to import content structures directly into the Workplace repository directly from any server drive (mount).
- **Document template library (Enterprise Edition only)**
Studio functionality to manage the end-user document templates and the OpenOffice.org template menu structure.
- **LDAP integration**
Organization's user and credential management can be imported from an existing LDAP deployment. The Workplace supports various standards, such as, OpenLDAP, Active Directory, Sun Directory Server and Novell Directory Server.
- **Document security**
The O3Spaces Workplace provides document security on different levels:
 - *Document security – Access control*
The Workplace allows you to control access to information through the integrated roles and rights management system.
 - *Document security – Secure Connections*
The Workplace can operate on encrypted (https) connections or if so desired in a vpn scheme.
- **OSGi plug-in framework**
Manage Workplace plug-ins and extension modules with the new OSGi Studio command interface.
 - Possibility to disable notifications from a specific user temporary.
- **OpenSearch**
The Workplace document repository is searchable by external systems and portals through our implementation of the OpenSearch specifications. This means that your documents and therefore your current information is easy to find while remaining securely stored in the the Workplace repository.
- **Performance & scalability**
Server side optimizations resulting in improved performance and scalability.

Release 2.4.0 - Patch 1 (32.56xx)

New features in release 2.4.0 patch 1 (build 32.56xx) are:

- **Improved content search:**
 - New file-parsing for the content search:
 - Better indexing of Microsoft Office files.
 - New file-types are indexed. For example Microsoft Visio Drawings; content of compressed files (zip, tar gzip, bzip)



Note: Only new published files will be indexed with the improved file-parser.

- **Option to deselect the workspace folder in the e-mail tab.**

The resolved defects in release 2.4.0 patch 1 (build 32.56xx) are:

- Blocking interface with loading-animation if overviews in inactive tabs are updating. In the meantime the user is not able to use the Workplace browser interface. (Performance and usability issue).
- E-mail archiving issues
 - Deleting and moving of files does not work if the Workplace e-mail plug-in is running. Errors occur.
 - Deleting a workspace with a configured folder in the e-mail does not work. Error: Failed to remove website.
 - Turning off the e-mail tab deletes the e-mail tab overview index.
 - In the Studio environment the e-mail tab is not always visible in opened workspaces.
 - Publishing e-mail messages from Microsoft Outlook gives an error if one there is one workspaces with an E-mail tab but without a Files tab configured.
- Installing the Office 2007 Workplace plug-ins fails sometimes with UAC enabled.
- Notifications of deleted files are not sent anymore.
- Getting started links in the Studio start screen doesn't function anymore.
- Canceling the 'Open from the Workplace' dialog from Office 2007 gives an error.
- The file-comments overview doesn't show formatted new lines.

OpenOffice.org / StarOffice plug-in

The O3Spaces Workplace incorporates the state-of-the-art plug-in for the OpenOffice.org and StarOffice office suites. The main plug-in features are:

- View & Open document versions as they are managed on the Workplace directly in the Office suite.
- Compare document versions of 'Writer' and 'Calc' documents.
- View & Add document comments.
- Export functions enabling e.g. PDF export of documents to the Workplace.
- Control your Workplace Assistant status.

OpenOffice.org / StarOffice plug-in prerequisites

The new OpenOffice.org / StarOffice plug-in utilizes the enhancements regarding OpenOffice.org / StarOffice extensions that have become available. Therefore the new plug-in requires the following office versions, respectively:

- OpenOffice.org 2.2, 2.3, 2.4, 3.0
- StarOffice 8 Update 5 or newer.
- JRE 1.5. or newer enabled in OOo / SO.

Note: See known issues section for details on Ubuntu OO.o packaging issues.

Important Note: No Office support on Mac OS X in 2.4.0

In O3Spaces Workplace 2.4.0 there is no Office support on Mac OS X.

O3Spaces will provide an OpenOffice.org 3.0 plug-in for Mac OS X as soon as OOo issue 93344

(http://qa.openoffice.org/issues/show_bug.cgi?id=93344) is fixed.



Microsoft Office plug-in

O3Spaces Workplace incorporates a plug-in for the Microsoft Office suite. The Microsoft Office plug-in allows basic Workplace interaction, such as opening a document from the Workplace directly and Publishing documents to the Workplace directly from

1. Microsoft Word
2. Microsoft Excel
3. Microsoft Powerpoint.

Other Microsoft Office components such as Microsoft Publisher interact with the Workplace, providing real-time locking and versioning, when opening documents from the Workplace browser UI, but lack the menu-entries.

Microsoft Office plug-in prerequisites

- The O3Spaces Workplace Microsoft Office plug-in is compatible with Microsoft Office XP, 2003 and 2007.
- Microsoft Office 2000 is currently supported with real-time locking and versioning, when opening documents from the Workplace Browser UI, but lack the Menu-entries.
- The Microsoft Office plug-in requires Microsoft .Net Framework 2.0 to be installed on the desktop computer
- Installation generally requires local administrative permissions

Microsoft Outlook plug-in (Enterprise Edition only)

O3Spaces Workplace 2.4.0 incorporates a new plug-in for the Microsoft Outlook application.

The Microsoft Outlook plug-in allows basic Workplace interaction; publishing e-mail messages to the Workplace directly from Microsoft Outlook and inserting files from the Workplace to new e-mail messages.

Microsoft Outlook plug-in prerequisites

- The O3Spaces Workplace Microsoft Office plug-in is only available in the Enterprise Edition
- The O3Spaces Workplace Microsoft Outlook plug-in is compatible with Microsoft Office 2003 (on Windows 2000, XP and Vista)
- The O3Spaces Workplace Microsoft Outlook plug-in is compatible with Microsoft Office 2007 (on Windows XP and Vista)
- The Microsoft Outlook plug-in requires Microsoft .Net Framework 2.0 to be installed on the desktop computer
- Installation generally requires local administrative permissions

Note: Publishing e-mail messages from Microsoft Outlook is only possible to workspaces with a correctly configured e-mail tab.

Using 'create new workspaces as Workspace user' functionality

To create new workspaces from the front-end Spaces environment a user needs 'create workspace' permissions on his Unit. To arrange this you have to assign an administrator role to the relevant users (or a group) on the Unit. **Important NOT to propagate this role assignment.** (Otherwise these users will get administrator permissions on all the workspaces within this Unit and below).

To avoid administrator problems the role-permissions of the default 'administrator' role is changed for new deployments. By default an 'administrator' is not allowed to visit the Workplace Studio. On existing deployments the administrator role-setting is not changed.



Known Issues

Note: For up to date information regarding know issues, fixes and updates please visit the O3Spaces Forums at:
<http://community.o3spaces.com/forum>

Localizations of Workplace 2.4.0 patch 1

The following localization are available in Workplace 2.4.0 patch 1

- | | |
|-------------|-----------------|
| 1. English | 100% translated |
| 2. Dutch | 99% translated |
| 3. French | 95% translated |
| 4. German | 99% translated |
| 5. Japanese | 88% translated |
| 6. Russian | 94% translated |
| 7. Spanish | 90% translated |
| 8. Swedish | 75% translated |
| 9. Polish | 97% translated |

The Norwegian localization is not available in Workplace 2.4.0 patch 1. Existing Norwegian profiles can continue working in Norwegian but many interface elements will be presented in English. Switching to a Norwegian profile is not possible.

Managing roles on sub-unit level

Since Workplace release 2.4.0, Workplace roles can only be managed on top-unit level. Eventually custom added roles on sub-unit level are deleted after updating to 2.4.0 or newer.

Un-install Workplace 2.1 plug-in before installing Workplace 2.4.0 plug-in

Before you install the O3Spaces Workplace 2.4.0 plug-in in your OpenOffice.org or StarOffice suite make sure you remove any Workplace 2.1.X plug-in you may have installed on your system. Failing to do so may result in a duplicate Workplace top-menu entry or plug-in installation issues.

Un-installing O3Spaces Workplace Debian or RPM packages.

Un-installing an O3Spaces Workplace Debian or RPM package crashes if the Workplace server is not running
Before un-installing a Debian or RPM package ensure yourself the Workplace server is running.

Two O3Spaces Workplace instances on one Tomcat Application Server

It is not possible to run multiple O3Spaces Workplace deployments (with different deployment version) on one Tomcat Application server. The 2.4.0 update requires a full Lucene and Compass re-index, which will fail if more Workplace instances are running on the same Tomcat server.

LDAP synchronization and maximum number of users

If the number of users in the LDAP tree exceeds the maximum number of Workplace user accounts in the Workplace license the synchronization operation will only succeed for the permitted number of users. Errors will be posted in the log files.



If on a re-synchronization existing users need to be replaced by new ones it is possible the maximum number of users is reached before the synchronization is finished, even if the desired end-result fits the maximum number of users. If you are a customer your O3Spaces vendor can supply a solution.

Downloads from IE fail over SSL

Workplace files cannot be downloaded from Internet Explorer if Tomcat is running over SSL. (Reference: https://issues.apache.org/bugzilla/show_bug.cgi?id=27122). An IE error appears with the message:

'Internet Explorer cannot download {filename} from {URL}. Internet Explorer was not able to open this Internet site, The requested site is either unavailable or cannot be found. Please try again later.'

A solutions is available:

The following className must be added to the context.xml file of Tomcat:

```
<Valve className="org.apache.catalina.authenticator.BasicAuthenticator"
securePagesWithPragma="false" />
```

Firefox and Java Web Start on Linux and Solaris operating systems

In some cases it is not possible to launch the Workplace Assistant from the Workplace Browser UI when running Firefox on Linux and Solaris operating systems. When starting the Workplace Assistant the Workplace persists that Java needs to be installed, even though a compatible JRE is installed on the machine.

This is due to a Java / Firefox configuration problem, i.e. an incomplete or missing Firefox Java plug-in installation. The issue can be resolved by creating a symbolic link to the Java plug-in in the Mozilla plug-ins directory.

To resolve the issue, please review the articles at:

http://java.sun.com/j2se/1.5.0/manual_install_solaris.html and/or <http://www.java.com/en/download/help/5000010500.xml#14>

Workplace on SLES

Running the Workplace on SLES doesn't work with the default IBM JRE enabled. Using SUN JRE / JVM is a functional workaround.

Safari and Java-check on Windows operating system

The Java-check fails in Safari (3.1) on Windows computers if 'Java SE 6 update 7' or lower is installed. (The check will succeed if Java SE 6 update 10 or greater is installed).

The Spaces interface shows an 'Java could not be detected' alert at the Workplace Assistant status indicator. To start the Workplace Assistant from the Spaces interface open the 'Java could not be detected' screen and click the button 'Start' below the sentence *'If you are sure Java is installed on this computer, start the Workplace Assistant here'*.

Context menus in Safari on Mac OS X

The context menus of Workplace items in the Spaces or Studio environment does not function correctly if Safari (3.1) is used on Mac OS X. The menu-items have no visual rollover feedback and sub-menus will not collapse.

This is an issue of the Safari Webkit: https://bugs.webkit.org/show_bug.cgi?id=17335



Non-ASCII characters in Firefox 1.5.X

When uploading and downloading documents using the Workplace browser interface filename containing Non-ASCII characters may be altered (Non-ASCII characters replaced) depending on the default character set on which your computer is operating. Upgrading your browser to Firefox 2.X will remedy this issue.

Opening multiple Workplace sessions in Browsers and/or Browser tabs

Browsers often utilize a single browser session for all active browser instances (Firefox) & tabs (Firefox & IE). When opening multiple Workplace UI's (e.g. different users, Studio & Spaces, etc.) the Workplace AJAX framework will be unable to determine the individual client state for the opened Workplace UI's.

(Opening multiple Workplace UI's in different Browsers, e.g. One in Firefox and one in IE generally presents no problems)

Using WebDAV connections on Windows XP and Vista operating systems

In order for WebDAV webfolders to function properly on Windows XP client machines the Windows patch KB892211 may need to be installed. For more information please review the article at: <http://support.microsoft.com/kb/892211>

By default setting up a WebDAV connection doesn't function on Windows Vista. In order for WebDAV webfolders to function properly on Windows Vista client machines the Windows updates KB907306 and/or KB942392 may need to be installed. For more information please review the articles at <http://support.microsoft.com/?kbid=907306>, <http://support.microsoft.com/?kbid=892211> and <http://support.microsoft.com/kb/942392>.

Keynote (.key) files on Mac OS X

On uploading a keynote file (.key) -or an application file (.app)- from Mac OS X to the Workplace, it will be recognized as a folder. Due to this issue it is not possible to upload a keynote file from the Spaces environment and on uploading using the Workplace Assistant the keynote file will be uploaded as a folder with the embedded keynote files as separate files in this folder.

This is a general Apple Keynote file issue:

"... You can generally save Keynote documents only to computers and servers that use Mac OS X. Keynote is not compatible with ... Windows servers running Services for Macintosh. ..."

(quote from <http://docs.info.apple.com/article.html?path=Keynote/4.0/en/c2kn6.html>)

A described workaround from the Apple website is to compress the file first before uploading.

References:

<http://docs.info.apple.com/article.html?path=Keynote/4.0/en/c2kn6.html>

<http://discussions.apple.com/thread.jspa?messageID=8343950>

<http://support.apple.com/kb/TS2133>

<http://red66.com/2008/02/how-to-send-keynote-presentations>

http://www.37signals.com/svn/archives2/trouble_with_directories_posing_as_files_in_browsers.php

OpenOffice.org 3.0 on Mac OS X

In O3Spaces Workplace 2.4.0 there is no Office support on Mac OS X.

O3Spaces will provide an OpenOffice.org 3.0 plug-in for Mac OS X as soon as OOo issue 93344

(http://qa.openoffice.org/issues/show_bug.cgi?id=93344) is fixed.



OpenOffice.org 2.2-2.4 on Ubuntu

The OpenOffice.org 2.2 - 2.4 versions packaged by and provided through the Ubuntu update networks is incompatible with the O3Spaces Workplace 2.4.0 OpenOffice.org plug-in.

The O3Spaces OpenOffice.org plug-in will not install on an out of the box Ubuntu Linux system of version 7.10 and newer. The problem is that the Java integration of OpenOffice.org is not installed by default.

The Java integration can be installed through the package 'openoffice.org-java-common'. You can either install the package with Synaptic, or run the following on the command line:

```
sudo apt-get install openoffice.org-java-common
```

Microsoft Office / Outlook plug-in installation for network installations

Currently the automatic detection of the Microsoft Office installation fails for Microsoft Office installations that are installed from a network path. Manual selection of the Office installation on the client computer will resolve this issue.

Using embedded Microsoft Excel OLE objects in Microsoft Word

Using embedded Microsoft Office Excel Worksheet Objects (OLE objects) in Microsoft-Word documents doesn't function well if the Workplace plug-in is installed in Microsoft Office. Word and / or Excel will crash if a just pasted OLE object is edited (double clicked) in Word.

This is an issue in Office 2003 and 2007.

A possible workaround in Office 2003:

- After pasting the OLE object in Word first close Excel. (make sure no EXCEL.EXE process is running).
- If Excel is closed you can double click the OLE object in Word without problems.

or

- After pasting the OLE object in Word first save and close the Word document
- After opening the Word document again you can double click the OLE object without problems.

Contact O3Spaces

O3Spaces B.V.

Hanzeweg 12d

2803 MC, Gouda

The Netherlands

+31 182 680 269

info@o3spaces.com | www.o3spaces.com | community.o3spaces.com

Disclaimer

All product names, logos, brands and any other trademarks contained in this document and the associated software are the property of the respective owners.



Copyright © 2006 - 2009 03Spaces B.V. All rights reserved.